

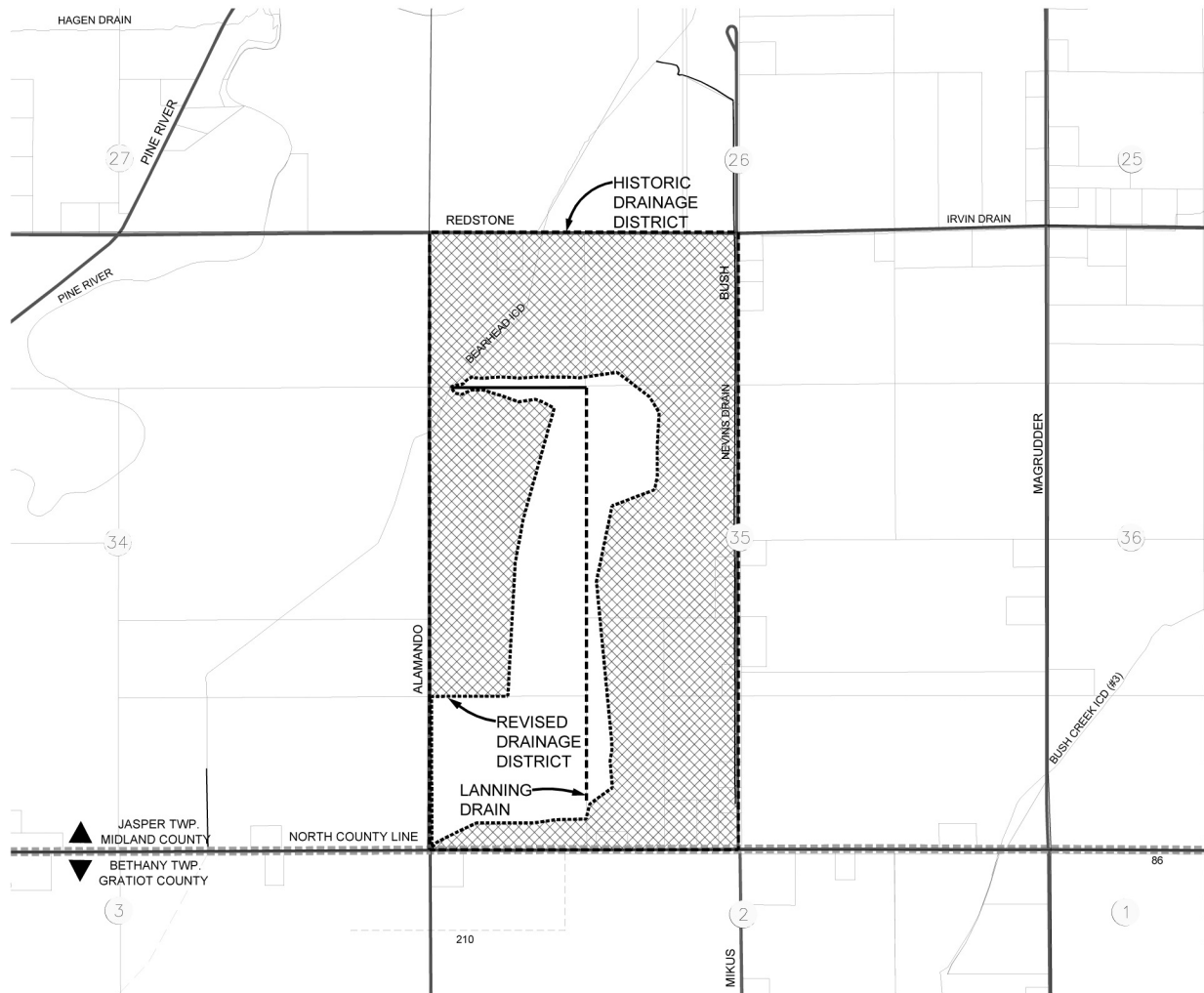

Lanning Drain

Section 35
T13N, R02W
Jasper Township, Midland County, Michigan



DRAINAGE DISTRICT INFORMATION:

HISTORIC DISTRICT:	320.00 ACRES
REVISED DISTRICT:	92.23 ACRES
LANDS ADDED:	0.00 ACRES
LANDS REMOVED:	227.77 ACRES
DRAIN LENGTH:	0.89 MILES

LEGEND

- LANDS REMOVED
- LANDS ADDED
- DRAIN ALIGNMENT (OPEN CHANNEL)
- DRAIN ALIGNMENT (ENCLOSED)
- HISTORIC DRAINAGE DISTRICT BOUNDARY
- REVISED DRAINAGE DISTRICT BOUNDARY
- CITY/VILLAGE LIMITS
- PARCEL LINES
- ROADS
- SECTION LINES
- TOWNSHIP LINE
- COUNTY LINE
- SECTION NUMBERS

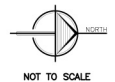

MAILING MAP

LRE ENGINEERS & SURVEYORS	2121 3 Mile Rd. NW Walker, MI 49544 Ph: 516.501.7888 www.LREMI.com	PROJECT#: 25-033 DRAWN BY: LGG DATE: JULY, 2025 DWG#: MFB